

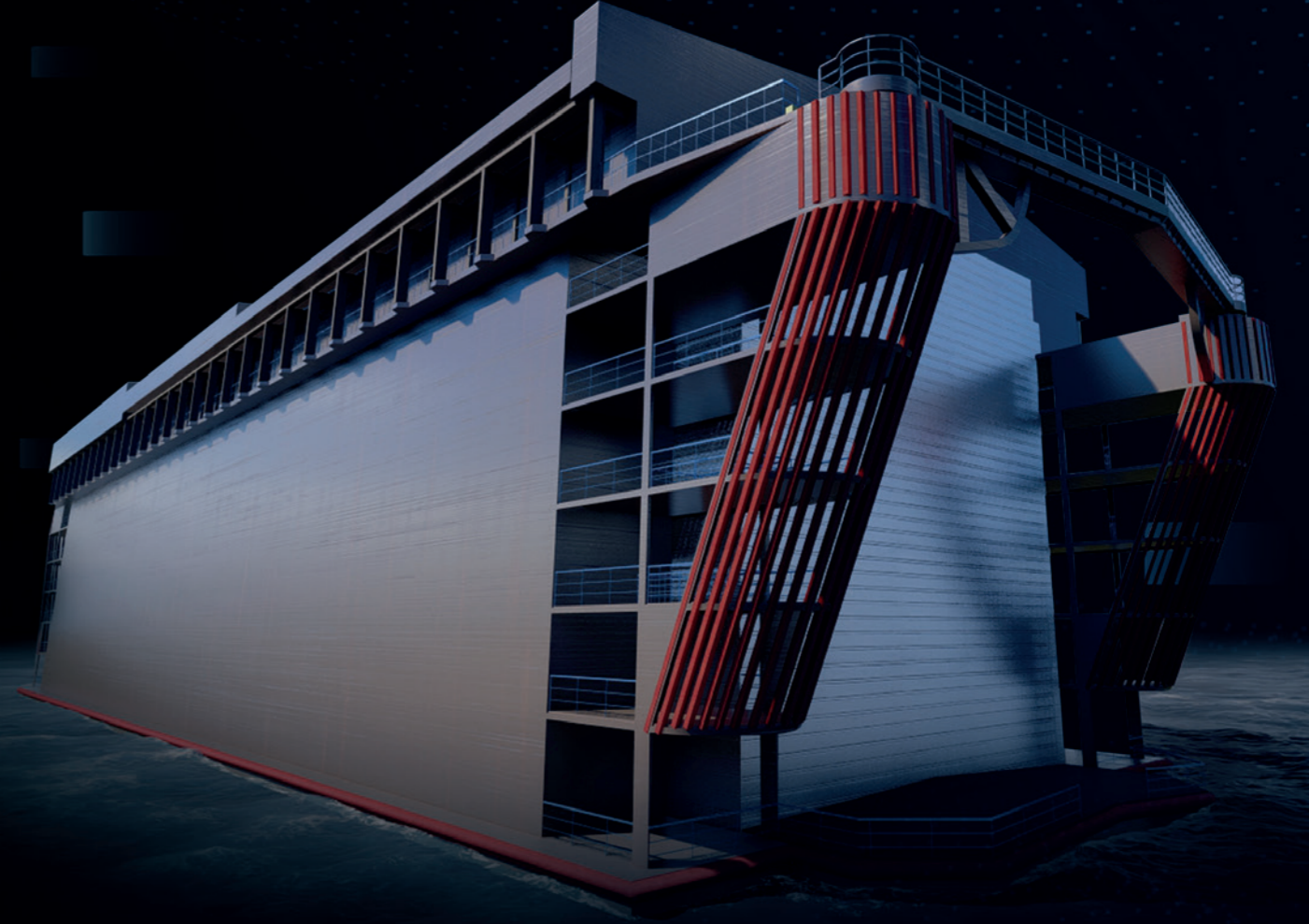

MSB\_ASFAT ASFAT msb\_asfat @asfat  
asfat.com.tr



# SUBMARINE FLOATING DOCK



**STRONGER TOGETHER**

# SUBMARINE FLOATING DOCK

Unique in the World

## GENERAL DIMENSIONS

**Length:** 90 m  
**Length Overall:** 105 m  
**Breadth (B):** 25,1 m  
**Breadth (BIC):** 17,05 m  
**Breadth Overall:** 26,65 m  
**Depth:** 19,9 m  
**Draught:** 12 m  
**Height of Lower Safety Deck:** 14,77 m  
**Height of Upper Safety Deck:** 17,36 m  
**Height of Crane Deck:** 19,95 m

## EQUIPMENT AND SYSTEMS

### ■ Automated Sliding Roof Systems

**Roof Length:** 87 m  
**Roof Width:** 27,8 m  
**Roof Height:** 3,9 m  
**Roof Weight:** 62.856 kg

### ■ 2 Automated Shutter Doors

**Beam Depth:** 1,2 m  
**Shutter Door Weight:** 16.500 kg  
**Door Height:** 22,5 m  
**Door Width:** 17 m

### ■ Cranes

**Lifting Capacity:** 10 tonnes, 20 tonnes  
**Lifting Speed:** 7 m/min (loaded)  
: 30 m/min (unloaded)  
**Moving Speed :** 5 m/min (loaded)  
: 20 m/min (unloaded)

### ■ 4x GENSETs

**Generator:** MRG - MSH - 600  
**Power:** 480 kWe  
**Power Factor:** 0,8  
**Frequency:** 50 Hz  
**Alternator:** Leroy Somer LSAM 49.3 M6

## GENERAL FEATURES

**Lifting Capacity:** 3000 tonnes  
**Diving Duration:** 75 min.  
**Personnel:** 28 Floating Dock Personnel  
and 14 Submarine Guarding Personnel  
**Tank Capacity:** 14046 m<sup>3</sup>  
**Roof:** Automated Sliding Roof System  
**Door:** 2x Automated Shutter Doors  
**Crane: Crane:** 2x Gantry Cranes with 10 Tonnes and  
20 Tonnes Lifting Capacity  
**Classificaiton Society:** Türk Loydu

